

Plot Date: 31 May 2022 16:22  
File Name: C:\Users\AdamH\Arden Management Ltd\Projects - P16 - GIS & CAD Files\030\_Ardg\_LBH\_BR\_CL\MXD\030\_Ardg\_LBH\_BR\_CL\_Ownership and Control\_Commercial\_r0v2.aprx

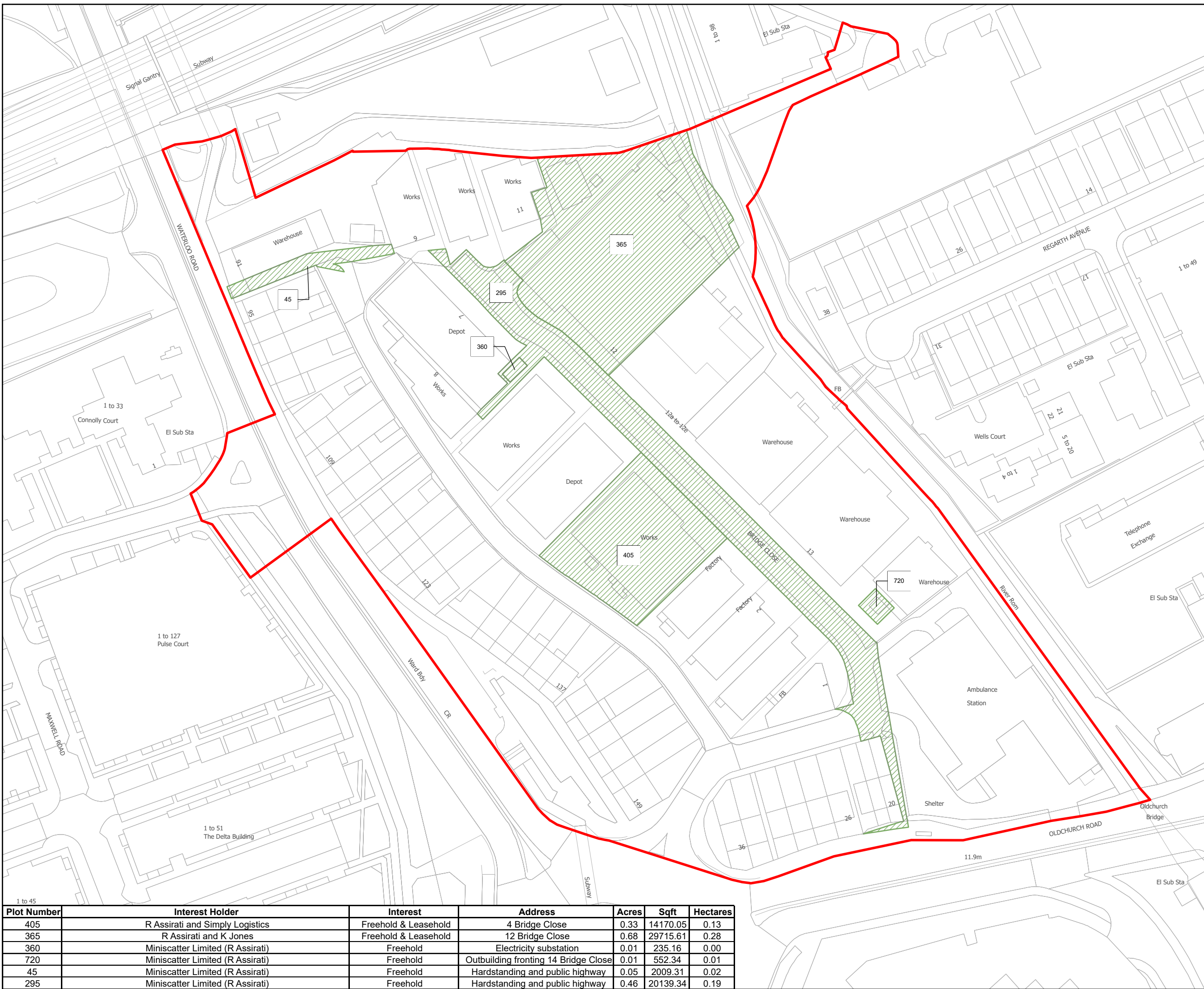

**Key**  
 Freehold interest in ownership of Raymond Daniel Assirati and Miniscatter Limited subject to agreement with Bridge Close Regeneration LLP

© Crown copyright and database rights 2022 Ordnance Survey 100024327. You are permitted to use this data solely to enable you to respond to, or interact with, the organisation that provided you with the data. You are not permitted to copy, sub-licence, distribute or sell any of this data to third parties in any form.

Client  
**THE LONDON BOROUGH OF HAVERING**

Designer

Project  
**BRIDGE CLOSE ROMFORD**

Drawing Title  
**ASSIRATI / MINISCATTER LAND OWNERSHIP / LAND CONTROL MAP COMMERCIAL TITLES**

Status	<b>DRAFT</b>	Revision	006
Date	31/05/2022	Drawn By	I.MAXIM
Scale	1:1,000 @ A3	Checked By	E.CORNELIUS
Spatial Reference System	British National Grid	Approved By	N.RUSHTON
Drawing reference	030_Ardg_LBH_BR_CL_Ownership		

This document is not to be used in whole or in part other than for the intended purpose and project for which it was prepared and provided.

Plot Number	Interest Holder	Interest	Address	Acres	Sqft	Hectares
405	R Assirati and Simply Logistics	Freehold & Leasehold	4 Bridge Close	0.33	14170.05	0.13
365	R Assirati and K Jones	Freehold & Leasehold	12 Bridge Close	0.68	29715.61	0.28
360	Miniscatter Limited (R Assirati)	Freehold	Electricity substation	0.01	235.16	0.00
720	Miniscatter Limited (R Assirati)	Freehold	Outbuilding fronting 14 Bridge Close	0.01	552.34	0.01
45	Miniscatter Limited (R Assirati)	Freehold	Hardstanding and public highway	0.05	2009.31	0.02
295	Miniscatter Limited (R Assirati)	Freehold	Hardstanding and public highway	0.46	20139.34	0.19

Plot Date: 31 May 2022 16:28  
 File Name: C:\Users\AdamH\Arden Management Ltd\Projects - P16 - GIS & CAD Files\030\_Ardg\_LBH\_BR\_CL\MXD\030\_Ardg\_LBH\_BR\_CL\_Ownership and Control\_Residential\_r6.aprx

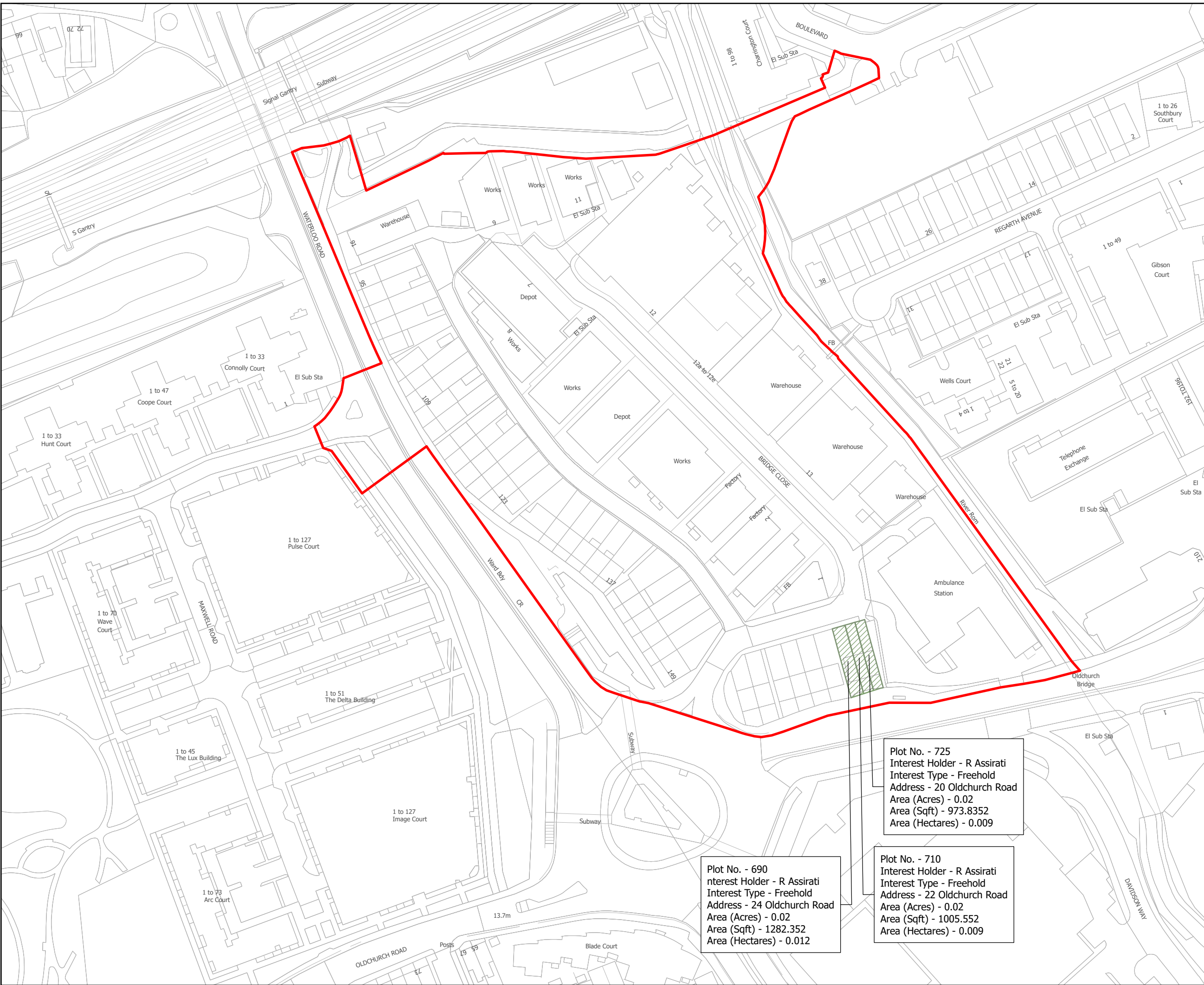

**Key**  
 Freehold interest in ownership of Raymond Daniel Assirati subject to agreement with Bridge Close Regeneration LLP

© Crown copyright and database rights 2022 Ordnance Survey 100024327. You are permitted to use this data solely to enable you to respond to, or interact with, the organisation that provided you with the data. You are not permitted to copy, sub-licence, distribute or sell any of this data to third parties in any form.

Client  
**THE LONDON BOROUGH OF HAVERING**

Designer  

Project  
**BRIDGE CLOSE ROMFORD**

Drawing Title  
**ASSIRATI / MINISCATTER LAND OWNERSHIP / LAND CONTROL MAP RESIDENTIAL TITLES**

Status	<b>DRAFT</b>	Revision	005
Date	31/05/2022		

Scale	1:1,250 @ A3	Spatial Reference System	British National Grid
Drawn By	I.MAXIM	Checked By	E.CORNELIUS
Approved By	N.RUSHTON		

Drawing reference  
**030\_Ardg\_LBH\_BR\_CL\_Ownership**

This document is not to be used in whole or in part other than for the intended purpose and project for which it was prepared and provided.

Plot No. - 725  
 Interest Holder - R Assirati  
 Interest Type - Freehold  
 Address - 20 Oldchurch Road  
 Area (Acres) - 0.02  
 Area (Sqft) - 973.8352  
 Area (Hectares) - 0.009

Plot No. - 710  
 Interest Holder - R Assirati  
 Interest Type - Freehold  
 Address - 22 Oldchurch Road  
 Area (Acres) - 0.02  
 Area (Sqft) - 1005.552  
 Area (Hectares) - 0.009

Plot No. - 690  
 Interest Holder - R Assirati  
 Interest Type - Freehold  
 Address - 24 Oldchurch Road  
 Area (Acres) - 0.02  
 Area (Sqft) - 1282.352  
 Area (Hectares) - 0.012